

Appendices

RFI 54 City Form Sections

North-South Nelson Street (East)

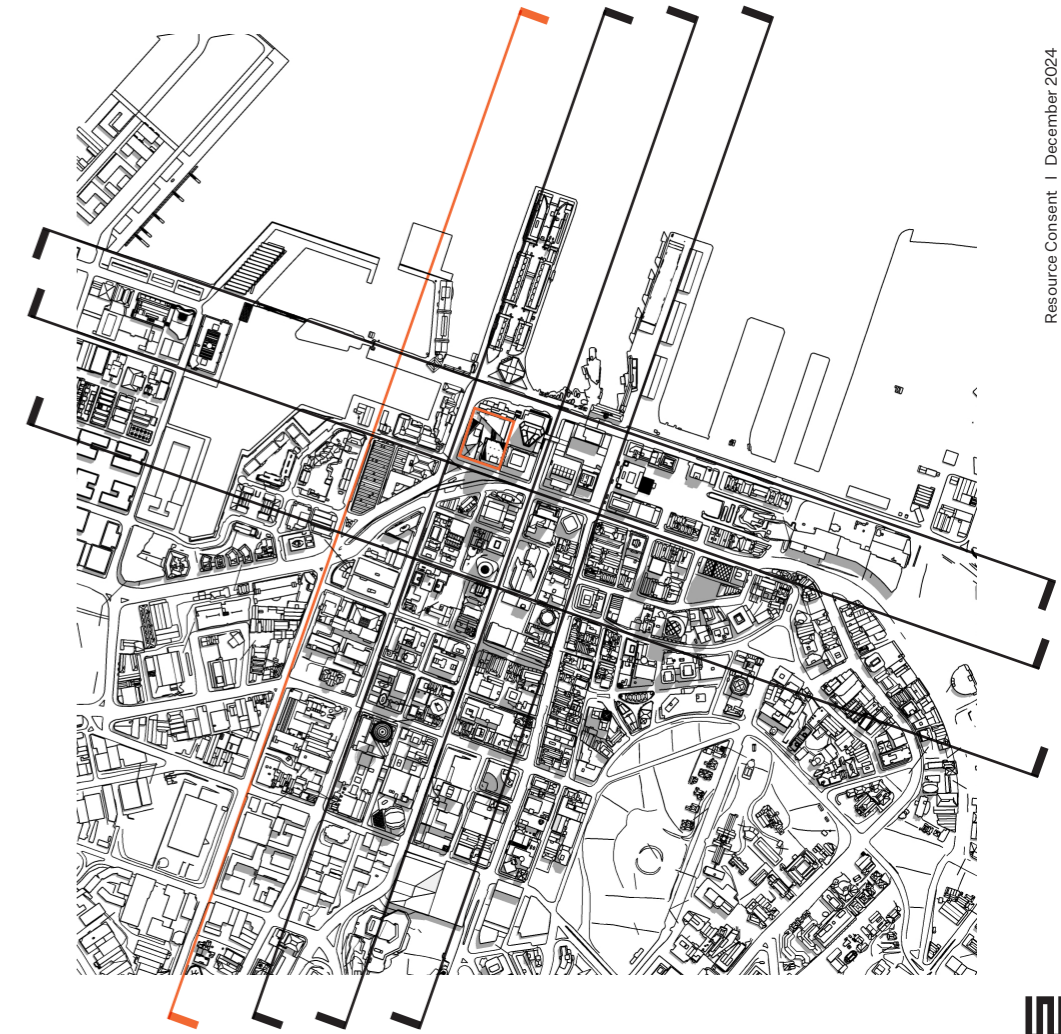

NELSON ST CROSS-SECTION LOOKING EAST
PROPOSED SCHEME + CITY CENTRE APPROVED / CONSENTED

-
NTS

-
NOTE: Cross-sections are generated from the Warren and Mahoney in-house digital model and assembled from various sources. Building forms are approximate representations rather than surveyed data. Topography is approximate and derived from GIS / Lidar data. Models of consented future development proposals are included and modelled based on public information sources.

RFI 54 City Form Sections

North-South Hobson Street (East)

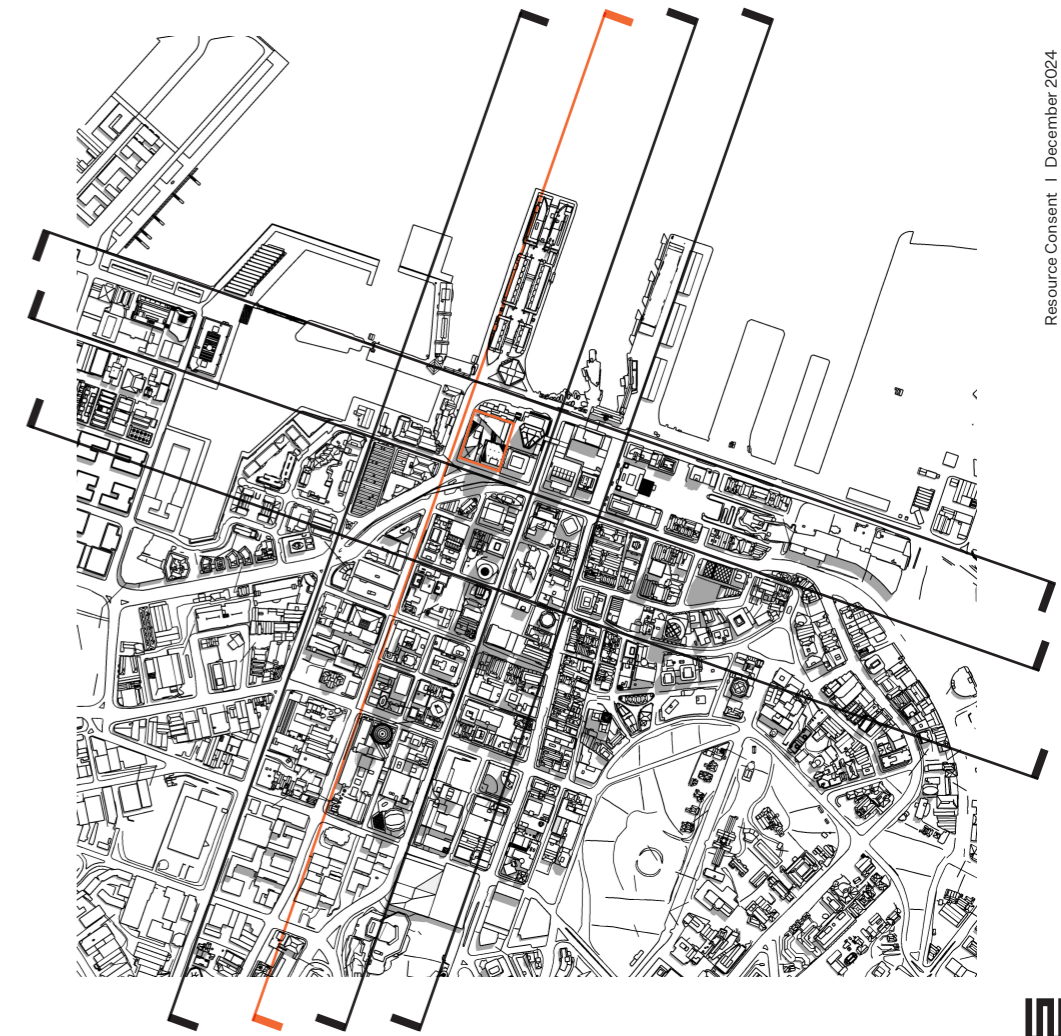

HOBSON ST CROSS-SECTION LOOKING EAST
PROPOSED SCHEME + CITY CENTRE APPROVED / CONSENTED

NTS

NOTE: Cross-sections are generated from the Warren and Mahoney in-house digital model and assembled from various sources. Building forms are approximate representations rather than surveyed data. Topography is approximate and derived from GIS / Lidar data. Models of consented future development proposals are included and modelled based on public information sources.

RFI 54 City Form Sections

North-South Albert Street (West)

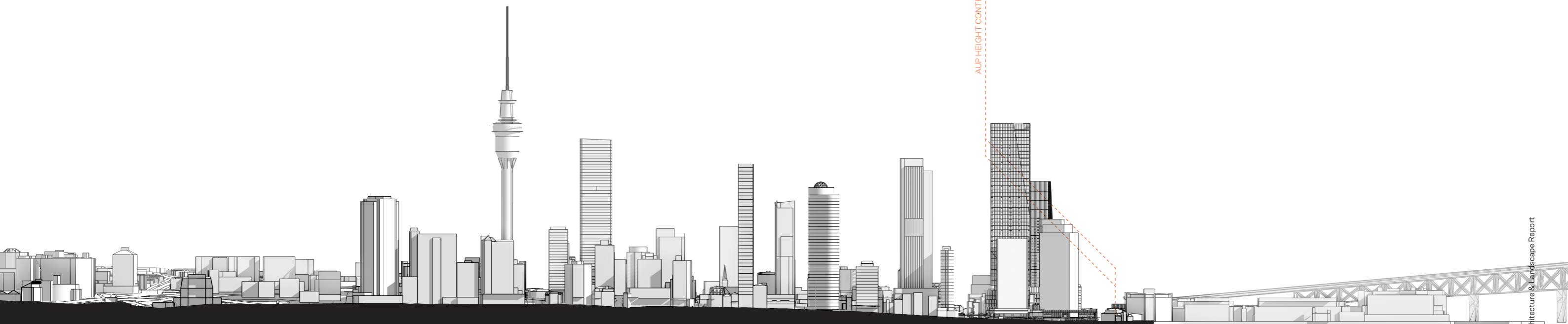
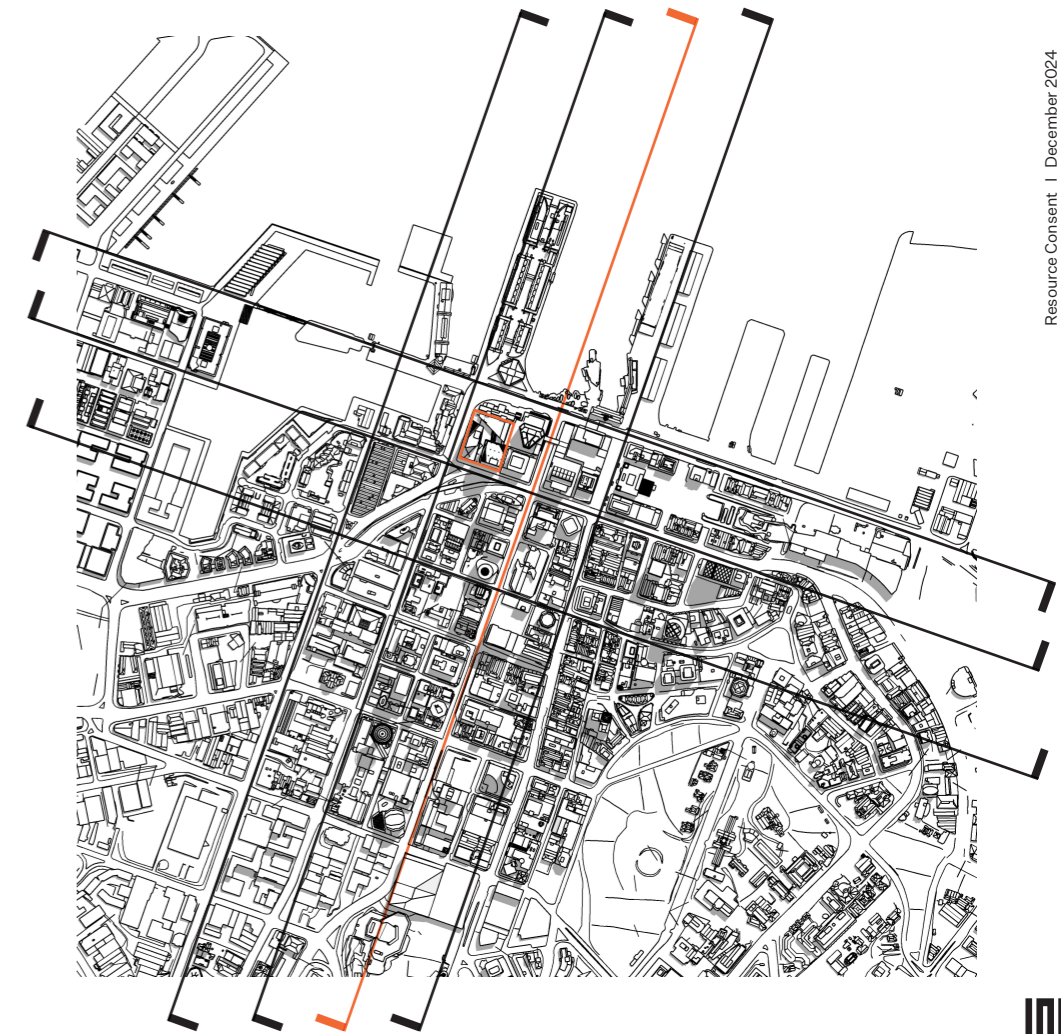

ALBERT ST CROSS-SECTION LOOKING WEST
PROPOSED SCHEME + CITY CENTRE APPROVED / CONSENTED

NTS

NOTE: Cross-sections are generated from the Warren and Mahoney in-house digital model and assembled from various sources. Building forms are approximate representations rather than surveyed data. Topography is approximate and derived from GIS / Lidar data. Models of consented future development proposals are included and modelled based on public information sources.

RFI 54 City Form Sections

North-South Queen Street (West)

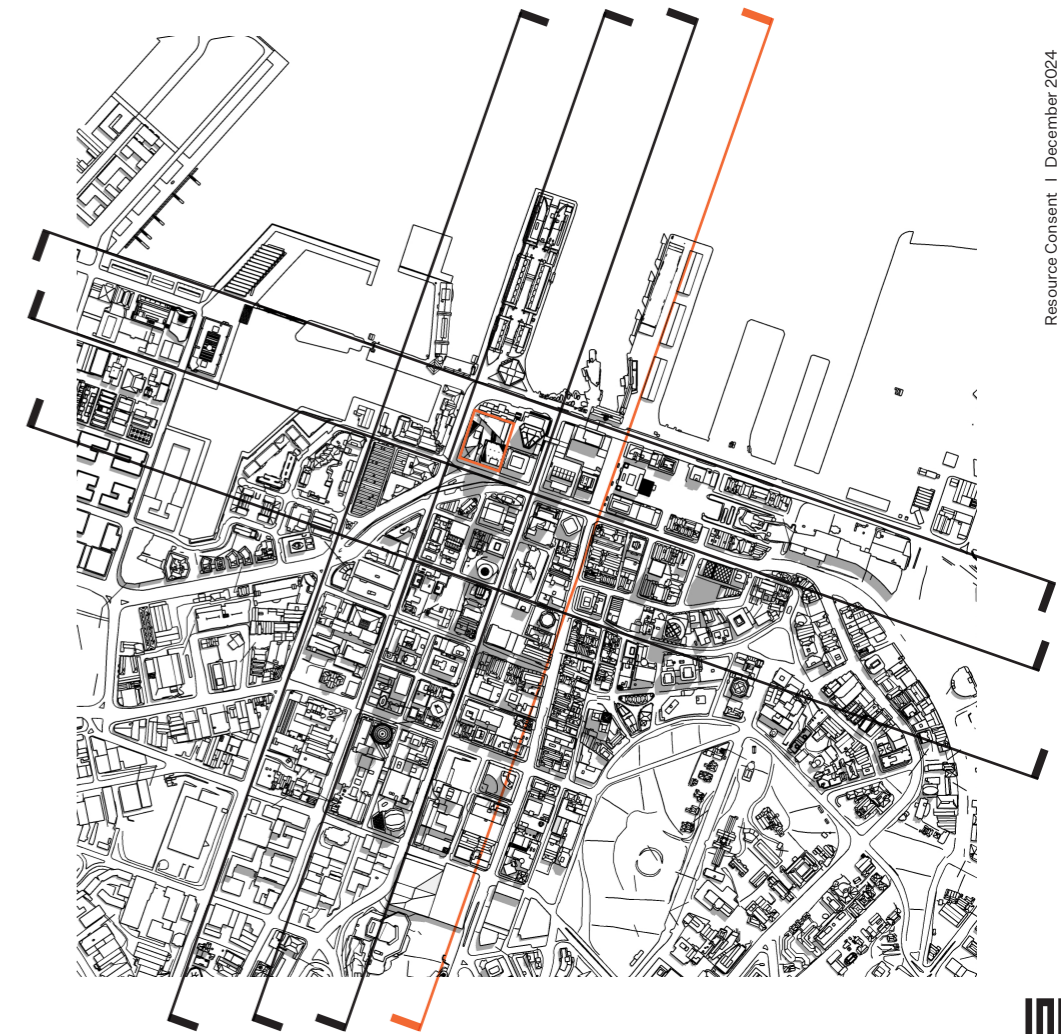

QUEEN ST CROSS-SECTION LOOKING WEST
PROPOSED SCHEME + CITY CENTRE APPROVED / CONSENTED

NTS

NOTE: Cross-sections are generated from the Warren and Mahoney in-house digital model and assembled from various sources. Building forms are approximate representations rather than surveyed data. Topography is approximate and derived from GIS / Lidar data. Models of consented future development proposals are included and modelled based on public information sources.

RFI 54 City Form Sections

East-West Quay Street (South)

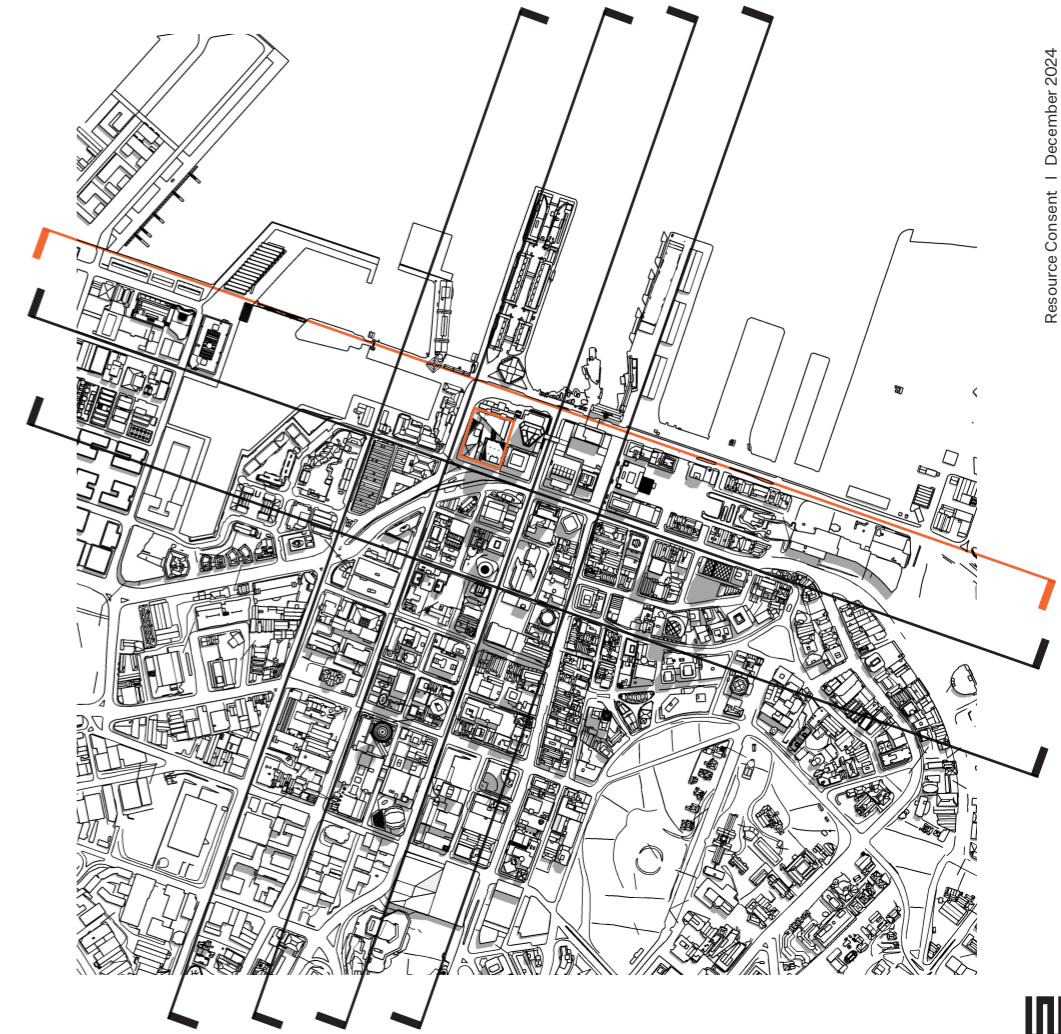

QUAY ST CROSS-SECTION LOOKING SOUTH
PROPOSED SCHEME + CITY CENTRE APPROVED / CONSENTED

-
NTS

-
NOTE: Cross-sections are generated from the Warren and Mahoney in-house digital model and assembled from various sources. Building forms are approximate representations rather than surveyed data. Topography is approximate and derived from GIS / Lidar data. Models of consented future development proposals are included and modelled based on public information sources.

RFI 54 City Form Sections

East-West Customs Street (North)

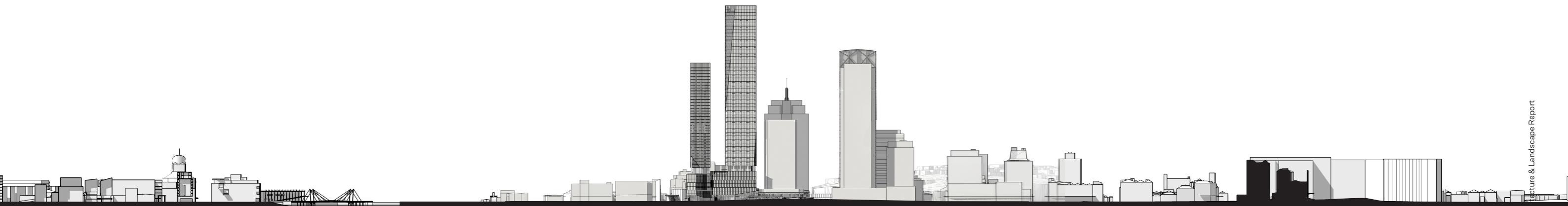
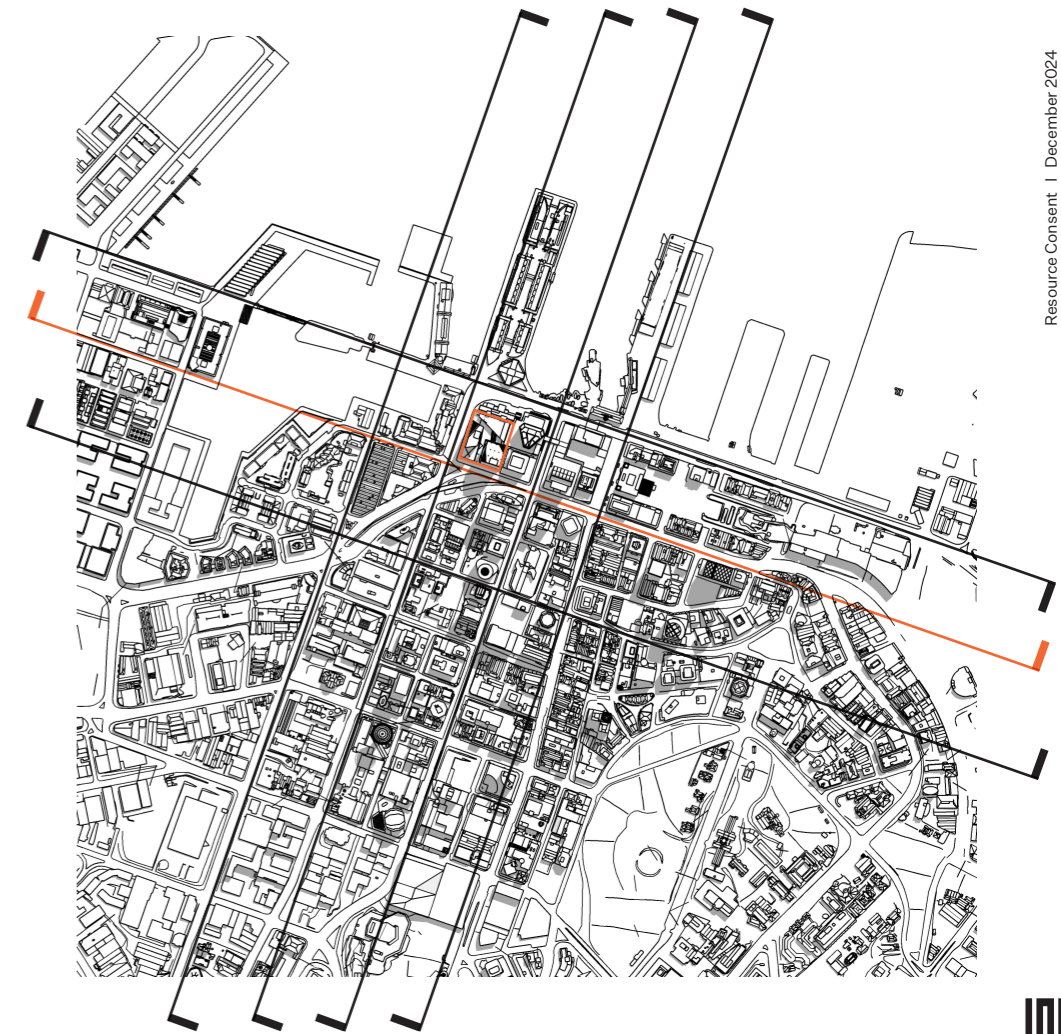

CUSTOMS ST CROSS-SECTION LOOKING NORTH
PROPOSED SCHEME + CITY CENTRE APPROVED / CONSENTED

NTS

NOTE: Cross-sections are generated from the Warren and Mahoney in-house digital model and assembled from various sources. Building forms are approximate representations rather than surveyed data. Topography is approximate and derived from GIS / Lidar data. Models of consented future development proposals are included and modelled based on public information sources.

RFI 54 City Form Sections

East-West Shortland Street (North)

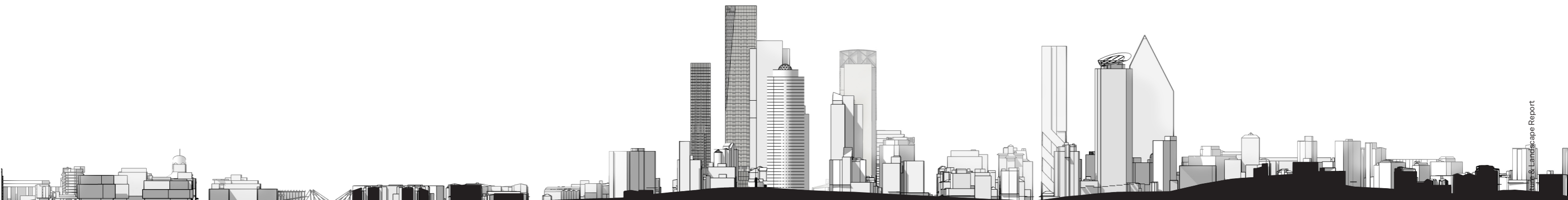
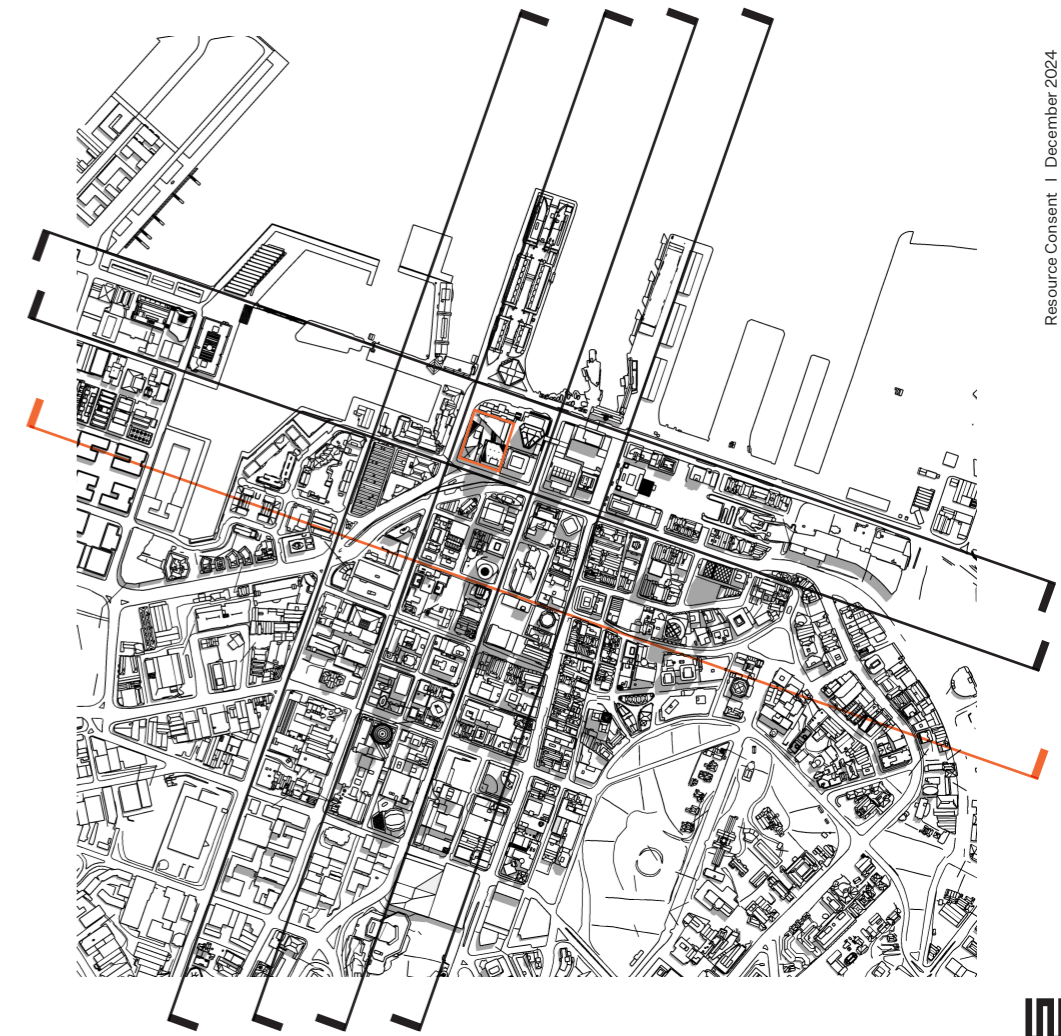

SHORTLAND ST CROSS-SECTION LOOKING NORTH
PROPOSED SCHEME + CITY CENTRE APPROVED / CONSENTED

-
NTS

-
NOTE: Cross-sections are generated from the Warren and Mahoney in-house digital model and assembled from various sources. Building forms are approximate representations rather than surveyed data. Topography is approximate and derived from GIS / Lidar data. Models of consented future development proposals are included and modelled based on public information sources.

RFI 58 (ii) Additional Model Render Views

View A Sturdee Street

NOTE: 3D renders aim to represent eye level view (1.68m above ground). Context shown is generated from the Warren and Mahoney in-house digital model and assembled from various sources. Building forms are approximate representations rather than surveyed data. Topography is approximate and derived from GIS / Lidar data. Models of consented future development proposals are included and modelled based on public information sources.

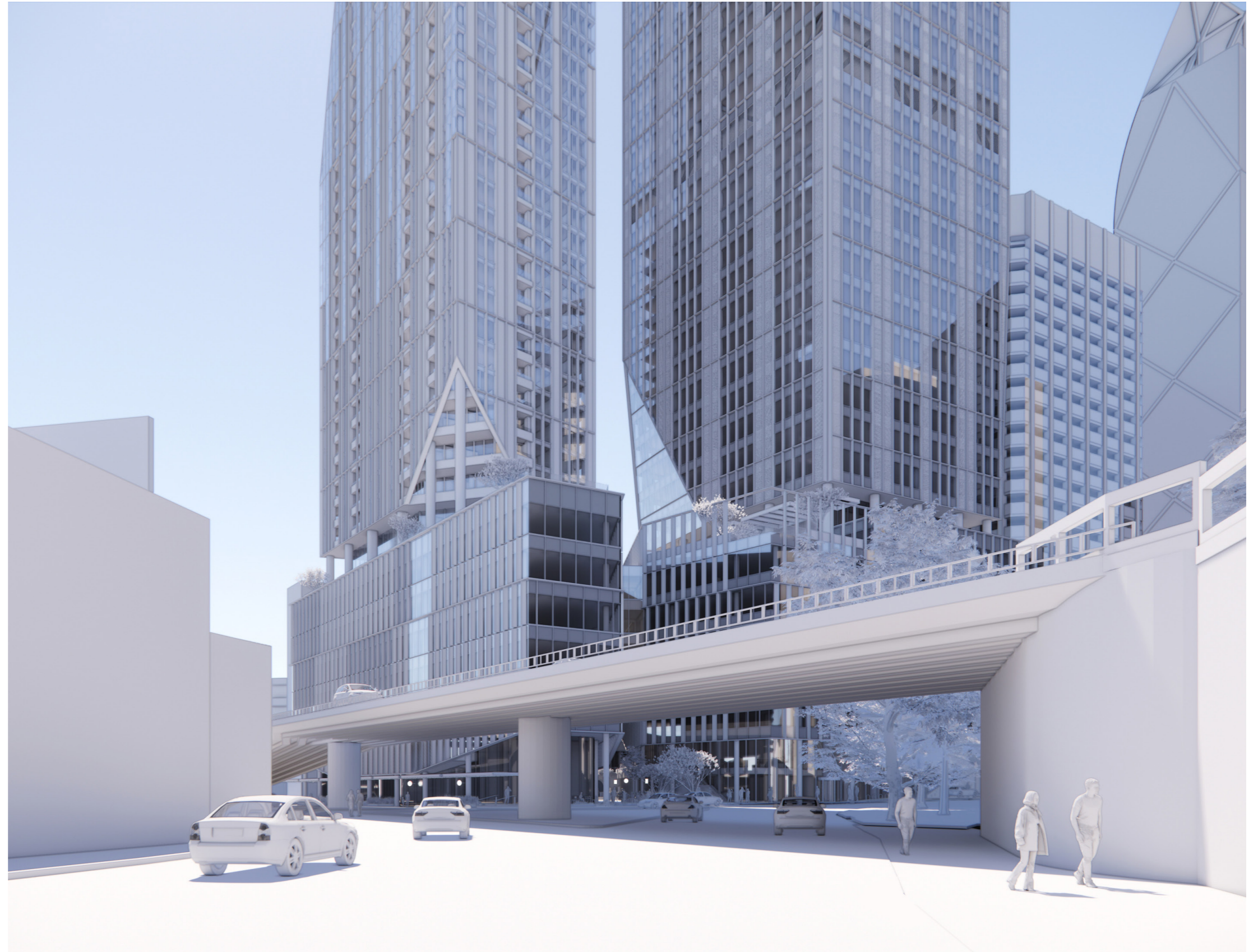

RFI 58 (ii) Additional Model Render Views

View B Historic Ramp

Note: existing trees ghosted in this view to reveal proposal

NOTE: 3D renders aim to represent eye level view (1.68m above ground). Context shown is generated from the Warren and Mahoney in-house digital model and assembled from various sources. Building forms are approximate representations rather than surveyed data. Topography is approximate and derived from GIS / Lidar data. Models of consented future development proposals are included and modelled based on public information sources.



RFI 58 (ii) Additional Model Render Views

View C

Lower Hobson Street East

NOTE: 3D renders aim to represent eye level view (1.68m above ground). Context shown is generated from the Warren and Mahoney in-house digital model and assembled from various sources. Building forms are approximate representations rather than surveyed data. Topography is approximate and derived from GIS / Lidar data. Models of consented future development proposals are included and modelled based on public information sources.

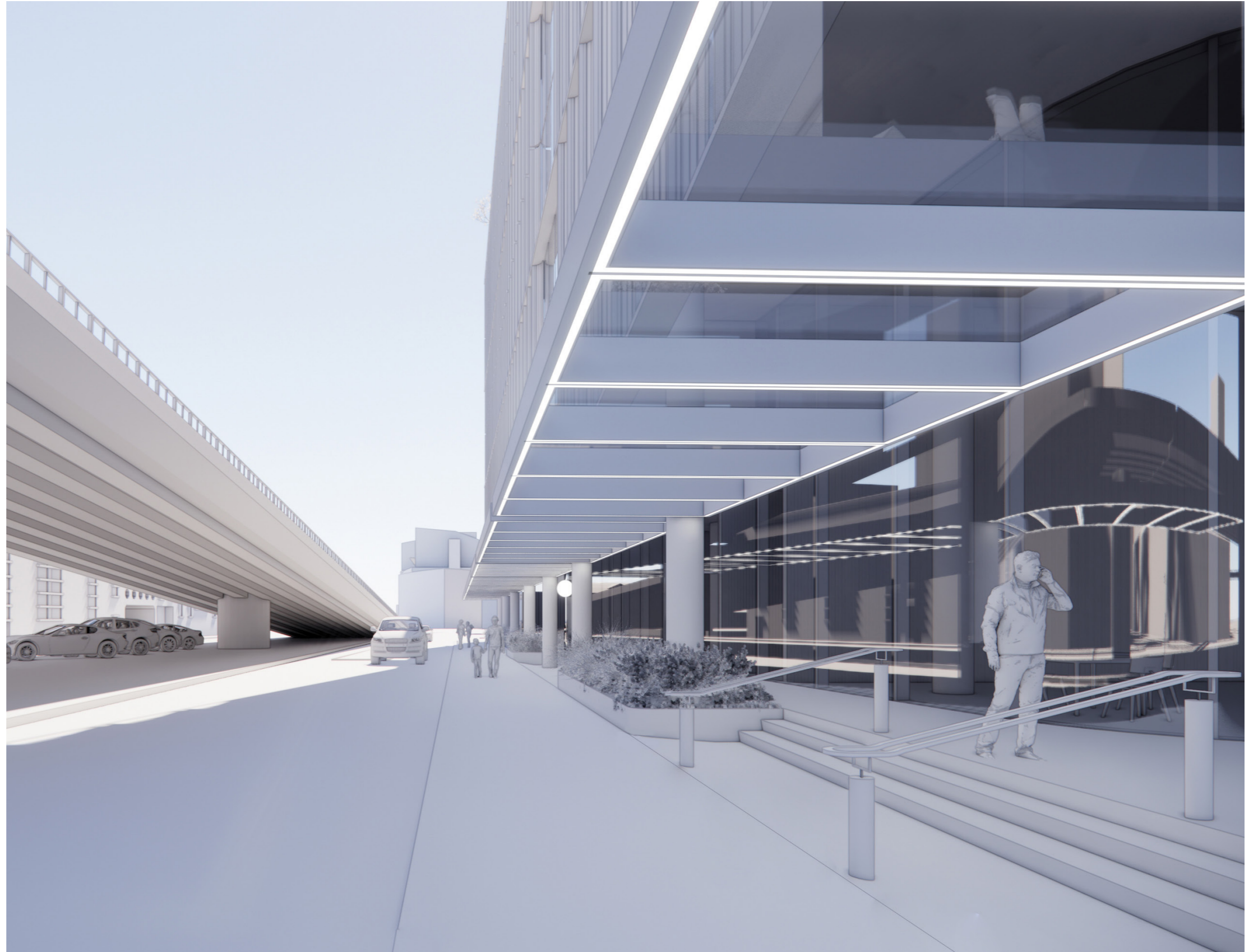
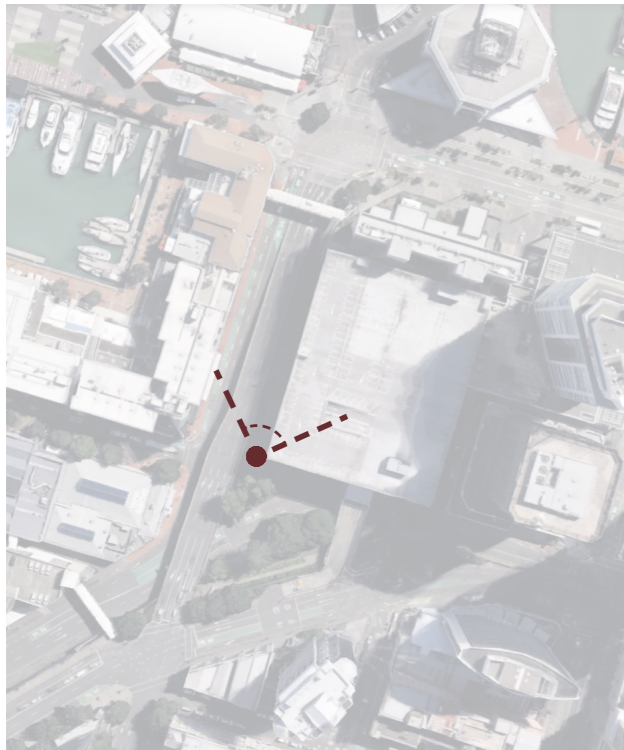

RFI 58 (ii) Additional Model Render Views

View D Lower Hobson Street West

NOTE: 3D renders aim to represent eye level view (1.68m above ground). Context shown is generated from the Warren and Mahoney in-house digital model and assembled from various sources. Building forms are approximate representations rather than surveyed data. Topography is approximate and derived from GIS / Lidar data. Models of consented future development proposals are included and modelled based on public information sources.

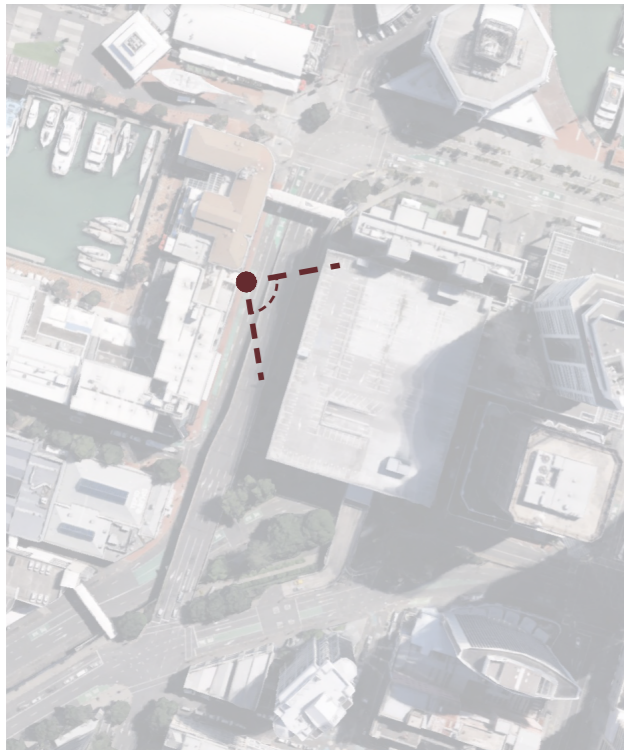

RFI 58 (ii) Additional Model Render Views

View E Quay St Corner

NOTE: 3D renders aim to represent eye level view (1.68m above ground). Context shown is generated from the Warren and Mahoney in-house digital model and assembled from various sources. Building forms are approximate representations rather than surveyed data. Topography is approximate and derived from GIS / Lidar data. Models of consented future development proposals are included and modelled based on public information sources.

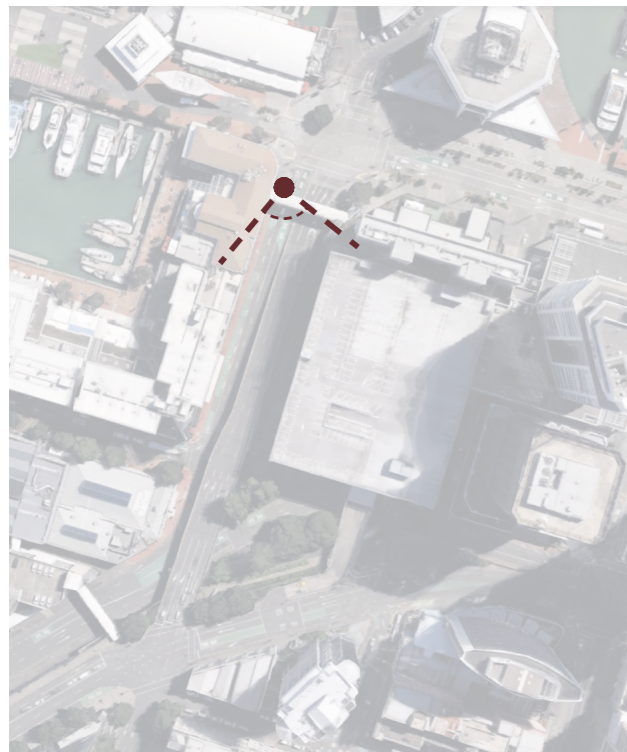

RFI 58 (iiv) Requested Viewpoint

Corner of Lower Hobson St
& Fanshawe St looking NE

Tower 2 Setback: 4.5m

NOTE: 3D renders aim to represent eye level view (1.68m above ground). Context shown is generated from the Warren and Mahoney in-house digital model and assembled from various sources. Building forms are approximate representations rather than surveyed data. Topography is approximate and derived from GIS / Lidar data. Models of consented future development proposals are included and modelled based on public information sources.

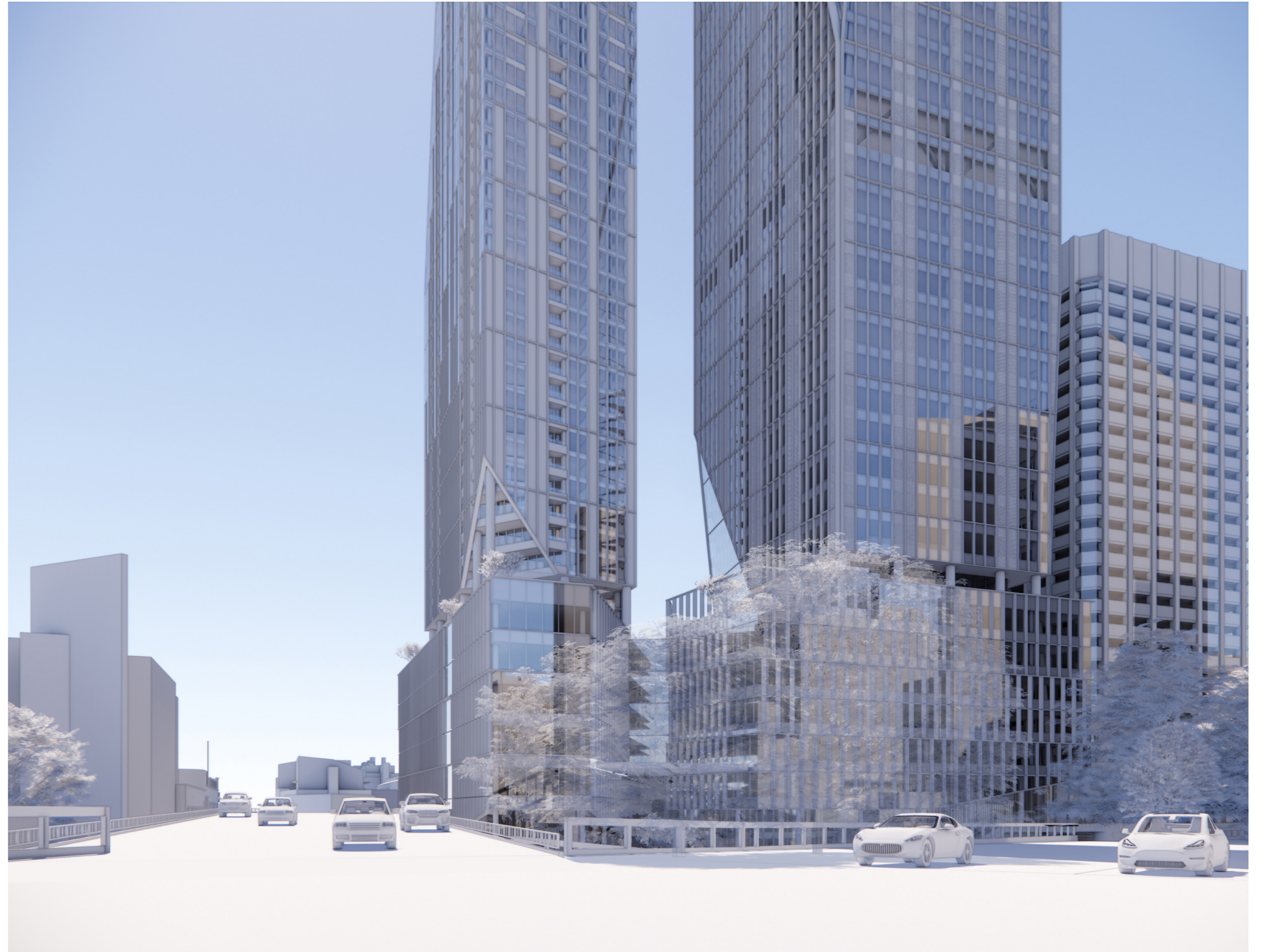
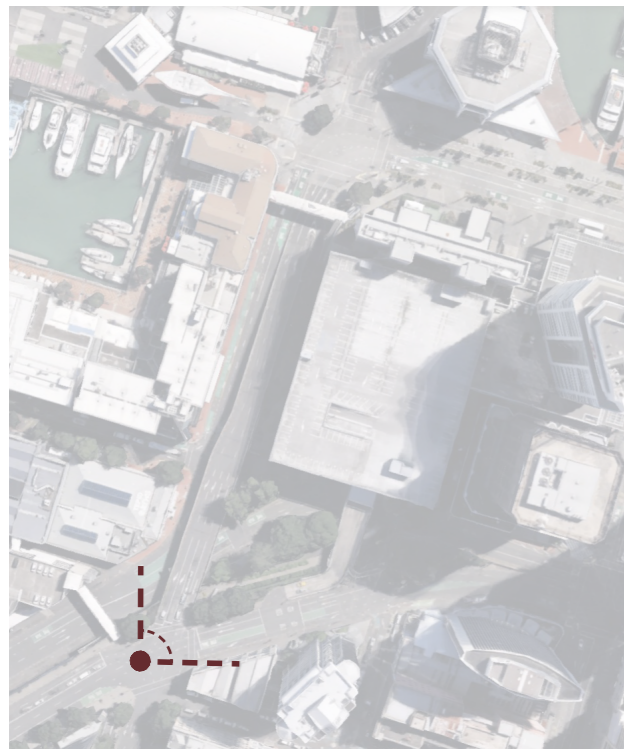

Note: existing trees ghosted in this view to reveal proposal

RFI 58 (iiv) Requested Viewpoint

Corner of Lower Hobson St
& Fanshawe St looking NE

Tower 2 Setback: 6m

Note: existing trees ghosted in this view to reveal proposal

NOTE: 3D renders aim to represent eye level view (1.68m above ground). Context shown is generated from the Warren and Mahoney in-house digital model and assembled from various sources. Building forms are approximate representations rather than surveyed data. Topography is approximate and derived from GIS / Lidar data. Models of consented future development proposals are included and modelled based on public information sources.

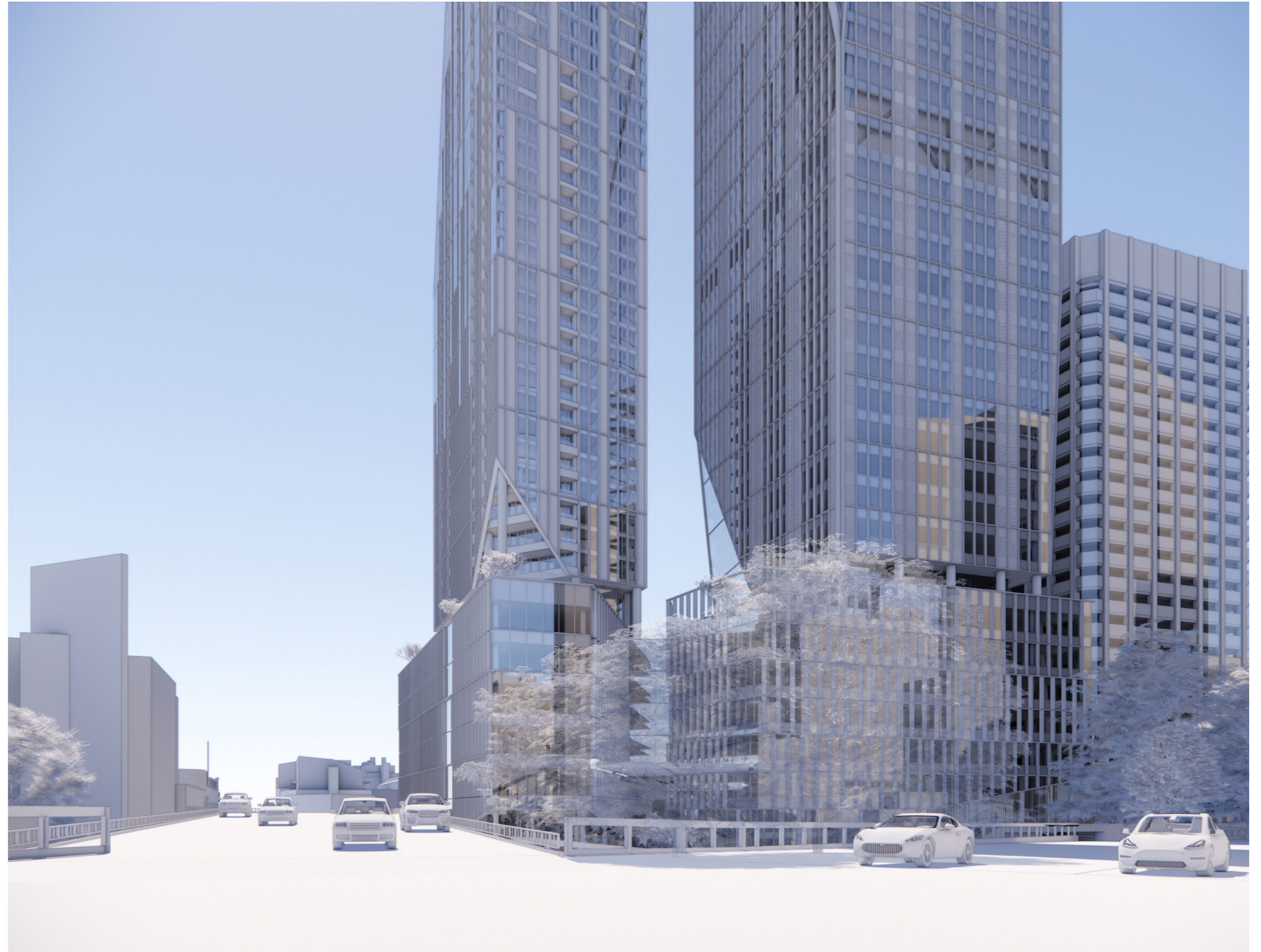

RFI 82 Viaduct Esplanade Sequence

NOTE: 3D renders aim to represent eye level view (1.68m above ground). Context shown is generated from the Warren and Mahoney in-house digital model and assembled from various sources. Building forms are approximate representations rather than surveyed data. Topography is approximate and derived from GIS / Lidar data. Models of consented future development proposals are included and modelled based on public information sources.



RFI 82 Viaduct Esplanade Sequence

NOTE: 3D renders aim to represent eye level view (1.68m above ground). Context shown is generated from the Warren and Mahoney in-house digital model and assembled from various sources. Building forms are approximate representations rather than surveyed data. Topography is approximate and derived from GIS / Lidar data. Models of consented future development proposals are included and modelled based on public information sources.



RFI 82 Viaduct Esplanade Sequence

NOTE: 3D renders aim to represent eye level view (1.68m above ground). Context shown is generated from the Warren and Mahoney in-house digital model and assembled from various sources. Building forms are approximate representations rather than surveyed data. Topography is approximate and derived from GIS / Lidar data. Models of consented future development proposals are included and modelled based on public information sources.



RFI 82 Viaduct Esplanade Sequence

NOTE: 3D renders aim to represent eye level view (1.68m above ground). Context shown is generated from the Warren and Mahoney in-house digital model and assembled from various sources. Building forms are approximate representations rather than surveyed data. Topography is approximate and derived from GIS / Lidar data. Models of consented future development proposals are included and modelled based on public information sources.



